

Base Cabinets

Base Cabinet with 1 Drawer, 1 Door, 1 Adjustable Shelf



B09
B12
B15
B18
B21

Base Cabinet with 1 Drawer, 2 Doors, 1 Adjustable Shelf



B24
B27
B30

Base Cabinet with 2 Drawers, 2 Doors, 1 Adjustable Shelf

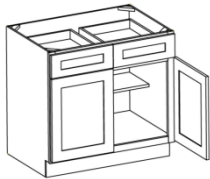

B33
B36

Base Cabinet with 3 Drawers

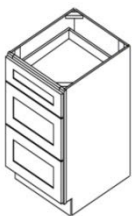

DB12-3
DB15-3
DB18-3
DB21-3
DB24-3
DB27-3
DB30-3
DB33-3
DB36-3

Sink Base Cabinet with 1 Dummy Drawer, 2 Doors

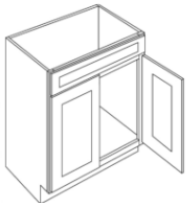

SB30

Sink Base Cabinet with 2 Dummy Drawers, 2 Doors



SB33
SB36
SB42

Trash Can Roll Out Tray with 2 cans.
Fits B18 and B21

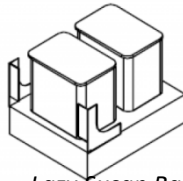

TCR2 1-2
Note: Includes 2 Plastic cans.

Lazy Susan Base Cabinet with 2 Full Height Folding Doors

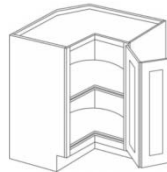

LS3309
LS3612
LS3612S
Note: only comes with shelves

Base Diagonal Cabinet with 1 Door, 1 Adjustable Shelf

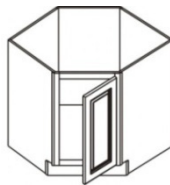

BDCF36
BDCF39
Note: This can Also be used as a corner sink base (Just leave out the shelf)

Base Blind Corner Cabinet with 1 Door, 1 Drawer, 1 Adjustable Shelf



BBLC39/42-36" W
BBLC42/45-39" W
BBLC45/48-42" W
Note: BBC39 door is 12" W, BBC42 door is 15" W, BBC45 door is 18" W.

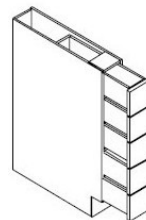

Base Spice Drawer
5 Spice Drawer

BSDC06-5

Base Spice Rack Cabinet with 1 Full Height Door (Pull Out) 3 Fixed Shelves

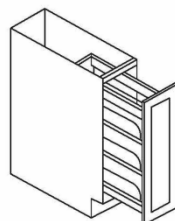

BSR09

Farm Sink Base with 2 Doors
FSB36B

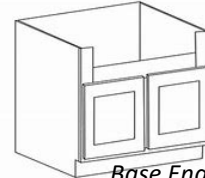

Base End Angle Cabinet
1 Door, 1 Fake Drawer, 1 Adjustable Shelf

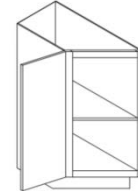

BTC12L
BTC12R

Base Open End Shelf 12" with No Door, 2 Fixed Shelves
Can use 2 wall shelves
Back to back

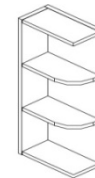

Knee Drawer with 1 Drawer

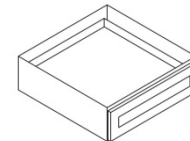

SVDU3021
5" Tall

Microwave Base Cabinet

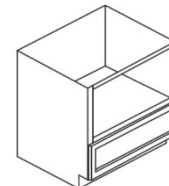

B30MW

Wall Cabinets

Wall Cabinet with 1 Door, 2 Adjustable Shelves (30")

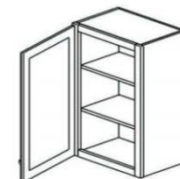

W0930
W1230
W1530
W1830
W2130

Wall Cabinet with 2 Doors, 2 Adjustable Shelves (30")

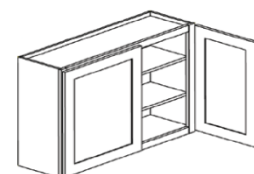

W2430
W2730
W3030
W3330
W3630



GraniteNetworksIndy.com
Granitenetworksindy@gmail.com
Call Mike 317-800-5100

Wall Cabinet with 1 Door, 2 Adjustable Shelves (36")

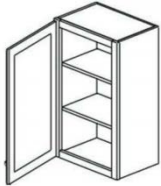

W0936
 W1236
 W1536
 W1836
 W2136

Wall Cabinet with 2 Doors, 1 Adjustable Shelf (24")

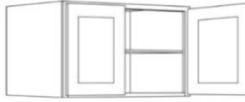

W3024
 W3324
 W3624

Wall Wine Rack Cabinet

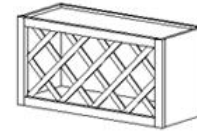

W3015WR
 W3615WR

Wall Cabinet with 2 Doors, 2 Adjustable Shelves (36")

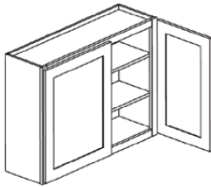

W2436
 W2736
 W3036
 W3336
 W3636

Wall Cabinet with 2 Doors, No Shelves (24" Deep)

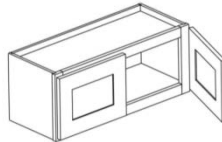

W361224
 W361824

"X" Style Wall Wine Rack Cabinet

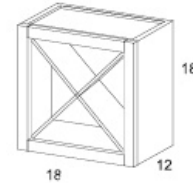

W1818WR

Wall Cabinet with 1 Door, 3 Adjustable Shelves (42")

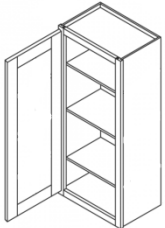

W0942
 W1242
 W1542
 W1842
 W2142

Wall Diagonal Corner with 1 Door, 2 Adjustable Shelves



WDC2430
 WDC2436
 WDC273615

Wall Open End Shelf No Door, 2 Fixed Shelves

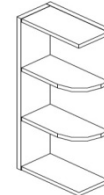

WES1230
 WES1236
 WES1242
 (3 Shelves)

Wall Cabinet with 2 Doors, 3 Adjustable Shelves (42")

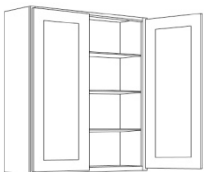

W2442
 W2742
 W3042
 W3342
 W3642

Wall Corner Cabinet with 1 Bi-Fold Door, 2 Adjustable Shelves

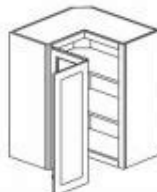

WSQ2430
 WSQ2436
 WSQ2442

Wall End Angle Cabinet with 1 Door, 2-3 Shelves (left or right)

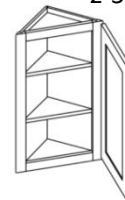

AW30
 AW36
 AW42

Wall Cabinet with 2 Doors, No Shelves (15" & 18")

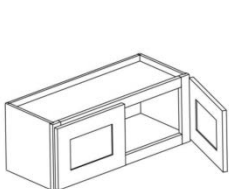

W3012
 W3612
 W3015
 W3315
 W3615
 W3018
 W3318
 W3618

Wall Diagonal Corner with 1 Door, 3 Adjustable Shelves

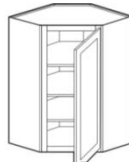

WDC2442
 WDC274215

Glass Door Only

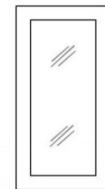

W1230GD
 W1530GD
 W1830GD
 W2130GD

Wall Blind Corner Cabinet



WBLC30/33-3030
 WBLC30/33-3036
 WBLC30/33-3042

Glass Door Only

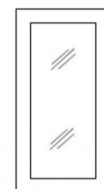

W2430GD
 W2730GD
 W3030GD
 W3330GD
 W3630GD

Wall Stem Glass Holder



SGH3012
 SGH3612



GraniteNetworksIndy.com
 Granitenetworksindy@gmail.com
 Call Mike 317-800-5100

Glass Door Only

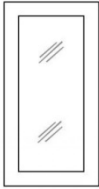

W1236GD
 W1536GD
 W1836GD
 W2136GD

Glass Door Only

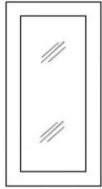

W2436GD
 W2736GD
 W3036GD
 W3336GD
 W3636GD

Glass Door Only



W1242GD
 W1542GD
 W1842GD
 W2142GD

Glass Door Only

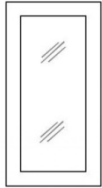

W2442GD
 W2742GD
 W3042GD
 W3342GD
 W3642GD

Glass Door Only



WDC2430GD
 WDC2436GD
 WDC2442GD

Glass Door Only

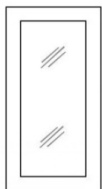

WDC273615GD
 WDC274215GD

Glass Door + Cabinet

(12") 1 Door

W1212GD(B&G)
 W1512GD(B&G)
 W1812GD(B&G)
 W2112GD(B&G)

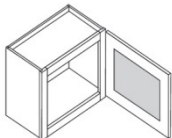

(12") 2 Doors

W2412GD(B&G)
 W2712GD(B&G)
 W3012GD(B&G)
 W3312GD(B&G)
 W3612GD(B&G)

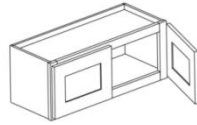

Wall Diagonal Corner (12") + Glass Door

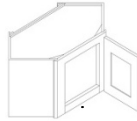

WDC2412GD (B&G)

Wall Microwave Cabinet

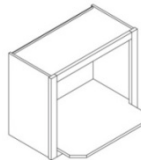

WMO3018
 PM-12

Tall Pantry with 1 Upper Door, 1 Lower Door

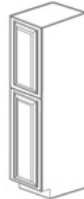

WP1884
 WP1890
 WP1896

Tall Pantry with 2 Upper Doors, 2 Lower Doors



WP2484B
 WP2490B
 WP2496B

Double Oven Cabinet with 2 Upper Doors, 1 Lower Drawer



OM3384B
 OM3390B
 OM3396B

Linen Cabinet with 1 Door, 2 Lower Drawers



W2D1848
 W2D1854
 W2D1860

Vanity Cabinets

Vanity Drawer Base Cabinet with 3 Drawers



3VDB12
 3VDB15
 3VDB18
 3VDB21

Vanity Sink Base Cabinet with 1 Dummy Drawer, 2 Doors

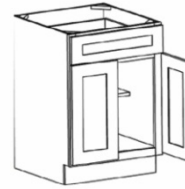

VSDB24
 VSDB30

Vanity Sink Base Cabinet with 2 Dummy Drawer, 2 Doors

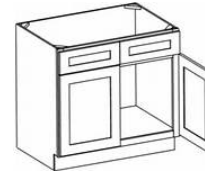

VSDB36

Vanity Sink Base Cabinet with Top Dummy Drawer, 2 Regular Drawers, 2 Door

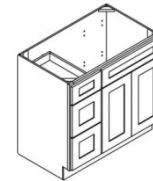

V3021DL
 V3021DR
 V3621DR
 V3621DL

Vanity Sink Base with 6 Drawers (3 on each side), 1 Door

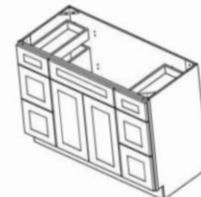

Vddb48
 Vddb60

Vanity Sink Base with 3 Middle Drawers, 2 Sink Bases

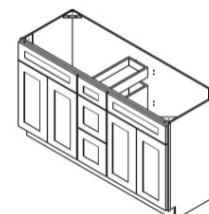

VSDB60



GraniteNetworksIndy.com
 Granitenetworksindy@gmail.com
 Call Mike 317-800-5100

Moldings & Accessories



Decorative Door Panel

- EPW1230D
- EPW1236D
- EPW1242D
- EPB24B

Decorative Door (2 Panels)

- EPWP2484D
- EPWP2490D
- EWPWP2496

Fluted Filler

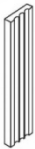

- A30WF
- A36WF
- A42WF
- A3BF
- A6BF

Wall Filler



- WF330-3/4
- WF336-3/4
- WF342-3/4
- WF630-3/4
- WF636-3/4
- WF642-3/4
- WF384-3/4
- WF396-3/4
- WF696-3/4

Base Filler



- BF3-3/4
- BF6-3/4

Dishwasher Panel



- DWR33412

Fridge Panel



- REP2496-3/4

- REP2496(3)-3/4



Back Skin Panel

- FBP48361/4 (1)
- FBP48961/4(1)
- FBP48963/4 (1)

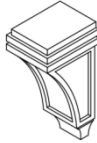

Corbel

- CORBEL75S
- CORBEL75M
- CORBEL75L

Cove Crown Molding (3" Tall)



- CM96K-4

Angled Crown Molding(3" Tall)

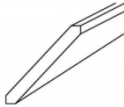

- CM96E-4

Crown Molding (2" Tall)

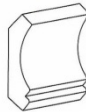

- CM96

Valance

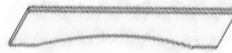

- VAL48S
- VAL54S
- VAL36
- VAL 42

3/4" Molding/ Light Rail Molding

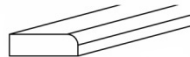

- ALRM8

Outside Corner Molding

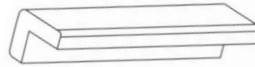

- SC5 (OMC)

Quarter Round Molding



- SHM8 1/4

Scribe/ Trim Molding



- SC1-3 (SM)

Inside Corner Molding

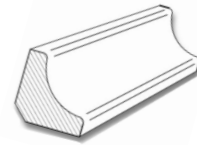

- SC4 (ICM)

Toe Kick



- TK8

Spool



- LEG75 B3x3

Roll Out Trays with Undermount Soft

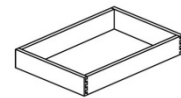

Close Track

- 15RT-DR
- 18RT-DR
- 21RT-DR
- 24RT-DR
- 27RT-DR
- 30RT-DR
- 33RT-DR
- 36RT-DR

Door Bumpers

Metal Clips

Soft Closed Drawer Glides

(For 24")

Soft Closed Drawer Glides

(For 21")

Soft Close Drawer Glides For Roll Out

Trays

Soft Close Hinges

Soft Close Hinges

(For Lazy Susan)

1/4" Thick-EP-Base Cabinet

1/4" Thick-EP-WXX30

1/4" Thick-EP-WXX36

1/4" Thick-EP-WXX42

Sample Door

Touch up kit